

Cleanup

STEDIA
ステディア

Made in Japan

Creating cheerful smiles from the kitchen

It always starts from Cleanup.

We are aiming to become a pioneer for society.
We will create scenes in life beyond the product.

We will make “The first time” in the kitchen
“The beginning” of every families’ smile.







A kitchen that keeps shining in your life.

STEDIA

3 items

Focusing and observing on the changing eras and life closely. Ceaseless passion has been brought when developing kitchens. All those experiences has been culminated to “STEDIA”. The 3 items will shine in your life.

- 01 Stainless Steel Eco Cabinet
- 02 e-Coat + Special embossed finish
- 03 Tool Pocket + Slide Box



01 Stainless Steel Eco Cabinet

Because it is a place that is usually hard to take care of. Stainless steel structure that resists mold and smell from humidity.

Your kitchen will be protected from mold, smell, and dirt.

Most manufacturers' kitchen cabinets are made out of wood.

On the other hand, stainless steel cabinets are equipped for STEDIA as a standard.

Stainless steel is a material that resists mold and smell.

A kitchen is something that is used everyday.

In order to maintain cleanliness, stainless steel is applied all the way towards the inside where it is usually hard to take care of.



Which is better against mold? "Stainless steel VS Wooden"

Material test was conducted comparing stainless steel used on our cabinets and wooden board. The testing was based on Japan Industry Standard Z 2911 mold resistance method. Growth rate of mold was compared by applying mold spore suspension on each material. After 4 weeks, mold does breed on both materials. However, looking through a microscope, the growth has stopped within the surface on stainless steel [Photo 1] where it has grown towards the inside of the material for wooden boards [Photo 2]. In addition, mold grows much faster on wood. After wiping off the mold from both materials using alcohol, they were left out on a hot and humid environment for a month. Mold was not found again on the surface of stainless steel, but it was on every wooden test subjects [Photo 3].

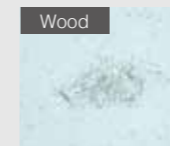
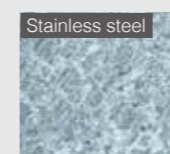

[Photo 1] Test result / Microscopic image
Mold spore (black dots) is germinated but is limited on the surface. It is not grown towards the inside.
(Based on our test conducted on June, 2019)

[Photo 2] Test result / Microscopic image
Mold has been spread out and germinated mold spore has penetrated towards the inside.
(Based on our test conducted on June, 2019)



[Photo 3] Test Result
Although germinated mold was wiped off, mold regrew on wood (Left).

※ Test was conducted in a highly humid and nutritious environment to accelerate growth of mold.



02 e-Coat + Special embossed finish

The countertop and sink will be protected from scratches and dirt with our original stainless steel processing technology.

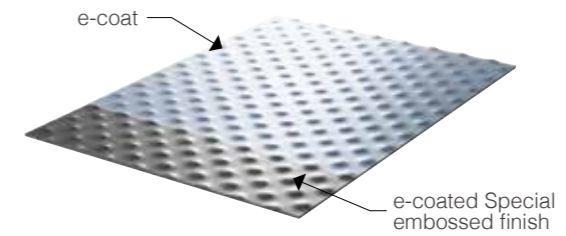

The e-Coat processing raises oil stains. (Special hydrophilic ceramic coating)

Tough oil stains can be removed easily by using a wet cloth or towel. By applying a special coating process that adapts well with water, dirt is raised from the stainless steel surface with water penetrating under the dirt.

Comparison of oil being wiped with wet cloth

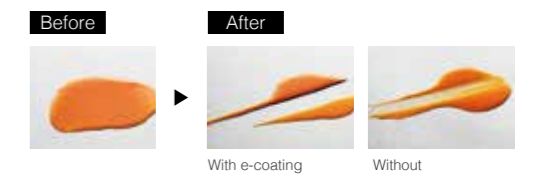

* 10 years worth durability is confirmed based on our company's testing standard for e-Coat (Special hydrophilic ceramic coating).

Scratch-resistant special embossed finish

The work surface that you use mostly has a special embossed processing applied which reduces contact with dishes or utensils. Scratches are less likely to form and become less noticeable when they do.

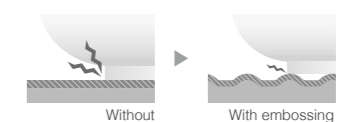



03 Tool Pocket + Slide Box

Drawers will become steric, by placing frequently used items towards the front.

Taking out and returning items is now more efficient.

All frequently used items can be stored in the front.

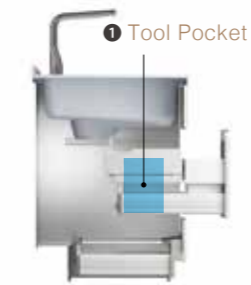

More frequently used items can be stored in the Slide Box.

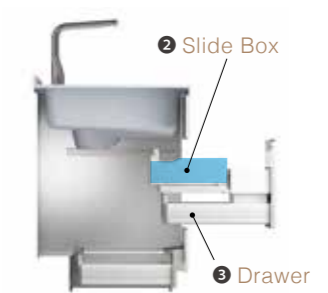

Sink Cabinet

All frequently used tools used around the sink can be organized and stored in the sink cabinet.

1 Tool Pocket



2 Slide Box



3 Drawer



Stove Cabinet

Pots, pans and also bottles can be stored under the stove which will make cooking more efficient.

1 Tool Pocket

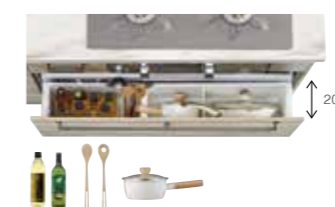

2 Slide Box



3 Drawer



PLAN 1

Dual Top Island
W2550 x D980
Door: Class 3
Sonata Wood Cherry (CPB)



PLAN 2

Dual Top Island
W2550 x D980
Door: Class 5
Roche Charcoal (E5H)



PLAN 3

Flat-Counter Island on wall
W2590 x D980
Door: Class 2
Bleu de Paris (CFV)
Blanc Casse (CFQ)



PLAN 4

Flat-Conter Island on wall
W2740 x D980
Door: Class 2
Stout Sirius (CFZ)
Cashmere Etoupe (CFL)



PLAN 5

Wall Fitting I-Shape
W2700 x D650
Door: Class 2
Beaute Silver (CJV)



PLAN 6

Dual Top Island
W2550 x D980
Door: Class 3
Luna Red (CNB)



PLAN 7

Wall Fitting I-shape
W2115 x D650
Door: Class 5
Classical Birch (C4B)



PLAN 9

Flat-Counter Island
W1880 x D980
Door: Class 3
Sonata Wood Walnut (CPL)



PLAN 8

Wall Fitting I-Shape
W2550 x D650
Door: Class 4
Cuir Camel (CBK)



PLAN 10

Wall Fitting I-Shape
W2400 x D600
Door: Class 5
Toile Grey (ECG)



COLOR LINEUP

Door — 49 colors —

class 1 [2 colors]



Stalia

Surface: Stainless Steel + Gloss Etching + Silk Printing + Clear Coat Finishing [HighGloss]
Edge: Top and Bottom Silver ABS Cap
Available Handles
B F G



Stalia Champagne (CVQ)

class 2 [8 colors]



Beaute

Surface: Stainless Steel + Gloss Etching + Silk Printing (Except Beaute Silver) + Clear Coat Finishing [High Gloss]
Edge: Top and Bottom Silver ABS Cap
Available Handles
B F G



Beaute Silver (CJV)



Beaute Bordeaux (CJH)



Beaute Rose (CJX)

class 3 [14 colors]



Luna

Surface: Vacuum Formed Acrylic Sheet + Crystal UV Coat [High Gloss]
Available Handles
B U F G T



Luna White (CNA)



Luna Red (CNB)



Renate

Surface: High Pressure Laminate [Matte]
Edge: High Pressure Laminate
Available Handles
E



Renate Natural (CDW)



Renate Grey (CDG)

class 4 [15 colors]



Crysta

Surface: Olefine Sheet Coated Decorative Panel + Crystal UV Coat [High Gloss]
Edge: UV Coat [High Gloss] on all sides. ABS edge
Available Handles
B U F G T



Crysta White (CYE)



Crysta Blue-Grey (CYW)



Crysta Red (CYB)



Liina

Surface: Olefine Sheet Decorative Panel [Matte]
Edge: Abstract pattern on all sides. ABS edge
Available Handles
B U F G T



Liina Rose (E5U)



Liina Brugge (E5V)

class 5 [10 colors]



Suede

Surface: FF Decorative Panel [Matte]
Edge: Single color on all sides. ABS edge
Available Handles
B U F G T



Suede White (CAT)

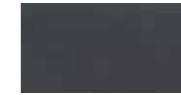

Suede Charcoal (CAZ)



Roche

Surface: FF Decorative Panel [Matte]
Edge: Abstract pattern on all sides. ABS edge
Available Handles
B U F G T



Roche Grey (E5K)



Roche Charcoal (E5H)



Ressac

Surface: Olefine Sheet Coated Decorative Panel [Matte]
Edge: Frame structure on all sides.
Available Handles
H J T



Ressac Herringbone (CVH)



Brocante

Surface: Urethane Coated Framed Door [Matte]
Edge: Urethane coat
Available Handles
H J T



Blanc Casse (CFQ)



Thiollet Rose (CFU)



Bleu de Paris (CFV)



Orion

Surface: Urethane Clear Coated Framed Door [Matte (Stardust Finishing)]
Edge: Urethane Clear Coat [Matte]
Available Handles
H J T



Cashmere Etoupe (CFL)



Stout Sirius (CFZ)



Patina

Surface: Vacuum Formed Acrylic Sheet + Crystal UV Coat [High Gloss]
Available Handles
B U F G T



Patina Opal (CHK)



Patina Marble (CHL)



Patina Jet (CHM)



Cerne

Surface: FF Decorative Panel [Matte]
Edge: Wood grain on all sides. ABS edge
Available Handles
B U F G K T



Mille Feuille Teak (CSK)



Ciel Oak (ESF)



Pottery Pine (CSL)



Sonata

Surface: Vacuum Formed Acrylic Sheet + Silk Touch UV Coat [Matte]
Available Handles
F G K T



Sonata Grise (CPG)



Sonata Sepia (CPZ)



Sonata Wood Cherry (CPB)



Sonata Wood Walnut (CPL)

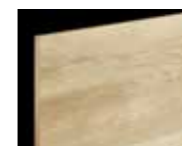

Fika wood

Surface: FF Decorative Panel [Matte]
Edge: Wood grain on all sides. ABS edge
Available Handles
B U F G T



Oak Latte (C3A)



Cherry Blend (C3B)



Elm Mocha (C3K)



Walnut Bitter (C3L)



Lys wood

Surface: Olefine Sheet Coated Decorative Panel + Crystal UV Coat [High Gloss]
Edge: UV Coat [High Gloss] on all sides. ABS edge
Available Handles
B U F G T



Pear Wood White (CWT)



Pear Wood Ash (CWX)



Marine Wood Dark (CWZ)



Cuir

Surface: Olefine Sheet Decorative Panel [Matte]
Edge: Leather tone on all sides. ABS edge
Available Handles
B U F G T



Cuir Chiffon (CBG)



Cuir Camel (CBK)



Cuir Olive (CBS)



Wood

Surface: FF Decorative Panel [Matte]
Edge: Wood grain on all sides. ABS edge
Available Handles
B U F G T



Nordic Beach (C4V)



Classical Birch (C4B)



Carbon Birch (E4Z)



Toile

Surface: FF Decorative Panel [Matte]
Edge: Single color on all sides. ABS edge
Available Handles
B U F G T



Toile Grey (ECG)



Toile Blue Grey (ECV)



Toile Rose (ECU)

Handle ■ Line Handle



B Line **U** Line Black

■ Long Bar Handle



F Long Bar Silver **G** Long Bar Black **K** Long Bar Antique

■ Special Handle



H Arch Silver **J** Cabriole Antique
T Cabriole Black



E Handleless (J Type)

Cabinet Color Lineup



White Wood (CRI) Natural Wood (CRC) Midium Wood (CRX) Dark Wood (CRY) Charcoal (CRR)

COUNTERTOP & SINK

Stream Flow Sink

With the water force during the vegetable washing while cooking or dish washing after meal, garbage in the sink swiftly flows into the drainage.



Help keep your sink clean

Water used during cooking will capture garbage and stains and flow towards the stream flow. Garbage flowing into the stream flow will be pushed away with water and into the drainage.



Silent water sound

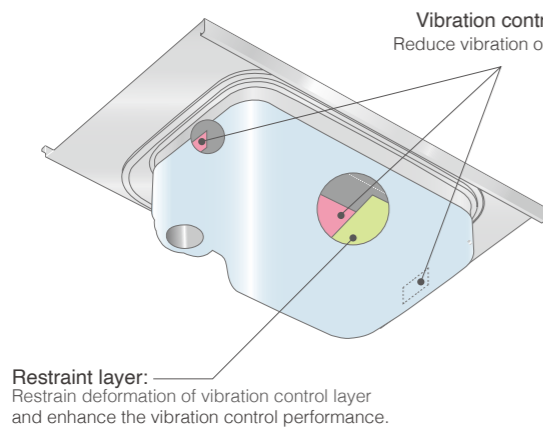

Phone level	70dB	
In noisy office Regular conversation	60dB	Conventional Sink
In regular office	50dB	
In library	40dB	Stream Flow Sink Super Silent Sink
	35dB	Silent Shower Faucet
Pendulum of wall clock Whispering	30dB	

Sink



Stainless Steel

Stream Flow Sink

Depth 65 cm



SY Sink ● W60 × D52 × H18.5 cm



SA Sink ● W75 × D52 × H18.5 cm

Stream Flow Sink Wide

Depth 65 cm



RW Sink ● W90 × D52 × H18.5 cm

Super Silent Sink

Depth 65 cm



SV Sink ● W67 × D52 × H20.4 cm



SK Sink ● W82 × D52 × H21.5 cm

Super Silent Sink

Depth 60 cm



SD Sink ● W65 × D48.5 × H18.3 cm



SB Sink ● W82 × D48.5 × H18.3 cm

Artificial Marble

Stream Flow Sink (AE Sink) ● W78 × D55 × H18.5 cm

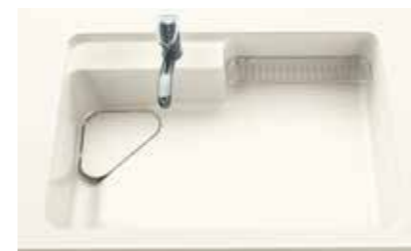

White (N)



Beige (G)



Mocha (R)



Blue Grey (B)

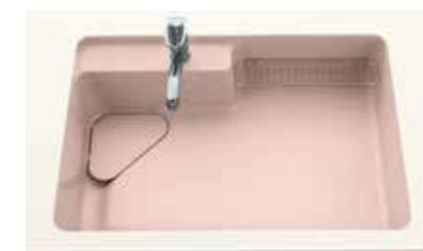

Coral (P)

A wide variety of unique countertops
Express anyway you like



Countertop



Stainless Steel



Dimpled finish (S)



Hairline finish (L)



Satin embossed finish (E)

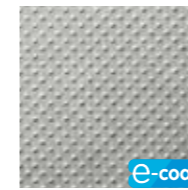

Vibration embossed finish (W)



Vibration finish (Z)

Ceramic

[Industrial]



Niliium (R)



Kreta (V)



Keranium (P)



Sirius (Q)

Corian

[Ortana]



Franc White (2)



Almond Natural (3)



Melty Noir (J)

Artificial Marble

[Solid]



Natural White (N)



Farina Beige (I)

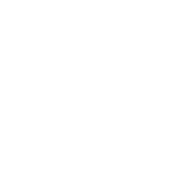

Russett Mocha (K)

FC Process



Flower White (H)

[Powder]



Sucre White (A)



Farina Beige (I)



Russett Mocha (K)

Color FC Process



Techi Tech (7)

[Caliza]



Caliza White (B)



Caliza Greige (Z)

Artificial Marble molding technology (Free Combination molding)



Cleanup's proud original artificial marble forming technology. Using the idea of "Inlaying"(A technique used when making antique furnitures.), a delicate but bold design is now available. Usability and strength of the countertop is same with or without the pattern, since a patterned piece using the same material is embedded.(Patent obtained)

COUNTERTOP & SINK

I-Shaped·L-Shaped Countertop / Stainless Steel / Artificial Marble / Corian / Ceramic

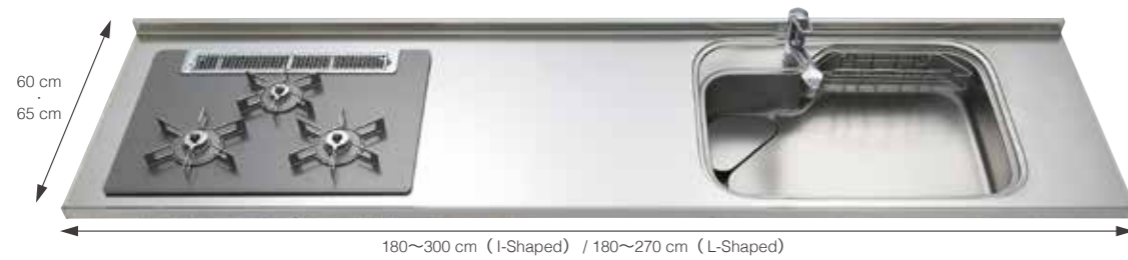

※ L-Shaped is not available when the countertop material is Corian and Ceramic.

Sink Variation

Stream Flow Sink (Stainless Steel)



SY Sink SA Sink

Stream Flow Sink Wide (Stainless Steel)



RW Sink

Stream Flow Sink (Artificial Marble)



AE Sink

Super Silent Sink (Stainless Steel)



SV Sink SK Sink

Super Silent Sink (Stainless Steel)



SD Sink SB Sink

Depth 60 cm

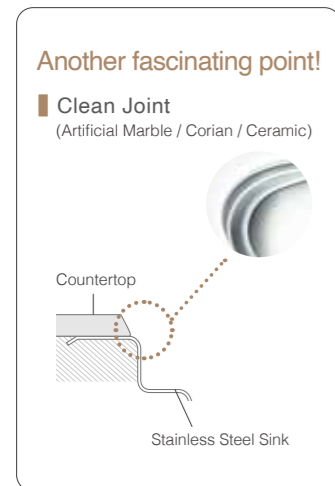

+ OPTION

		Lid for Drainage	Support Plate	Cutting Board	Cutting Board Rack	Draining Basket	For both
For Stream Flow Sinks	SY·SA·RW Sink		Stainless Steel / Artificial Marble / Ceramic ZKPPJN-K Corian ZKPPEN-K	—	ZKPAHN-K	ZKPNNN-K	ZKPBNN-K
	AE Sink		ZKPPCN-K	—	—	—	
For Super Silent Sinks	SV·SK Sink		For SV Sink : MP-9 For SK Sink : ZKPPKN-K (Photo shows SV Sink)	For SK Sink MHK-1	ZKPAKN-K	PMC-K	ZKPKNN-K
	SD·SB Sink		For SD Sink : ZKPPUN-K For SB Sink : ZKPPGN-K (Photo shows SB Sink)	—	ZKPATN-K	ZKPNNTN-K	ZKB075NA-K

COUNTERTOP & SINK COMBINATION

		I-Shaped · L-Shaped Countertop				Flat Counter Island			
		Stainless Steel	Artificial Marble	Corian	Ceramic	Stainless Steel	Artificial Marble	Corian	Ceramic
Stream Flow Sink	Stainless Steel	●	●	●*1	●*1	●	●	●*2	●*2
	Artificial Marble		●	●*1			●	●	
Super Silent Sink		●*3	●*3				●*3		

*1 L-Shaped Countertop is not available.
*2 SY Sink is not available.
*3 Super Silent Sink is not available for Flat Counter L-Shaped

Flat Counter Island / Stainless Steel (Hairline) / Artificial Marble / Corian / Ceramic



※ L-shape is not available when the countertop material is Stainless Steel, Corian and Ceramic.
※ Depth 80 cm countertop is only available Stainless Steel and Artificial Marble.

Sink Variation

Stream Flow Sink (Stainless Steel)



SY Sink



SA Sink



RW Sink

Super Silent Sink (Stainless Steel)



SV Sink



SK Sink

Stream Flow Sink (Artificial Marble)



AE Sink

Front Screen (for Flat Counter)

Standard Spec



Low type

+ OPTION



High type

FLOOR CABINET

Keep all regularly used items in the Handy Area

Keep all frequently used items in the “Handy Area” and store infrequently used items in the “Floor Container”. Also, separate items in multiple spaces according to different duties such as heating, cutting, and washing. An efficient kitchen is created by reducing unnecessary space and unnecessary movements.



※ The width shown in the image is 255 cm

Innovations that make things easy to reach and using

- Silent Rail**
- Full Extension Rail**
- Floor Container**
 - High Capacity
 - Moderate clearance from the floor
 - Scratch resistant aluminum riser
 - Front Side Tray

	Cooking area	Set-up area	Washing-up area
	Stove Cabinet (width 75 cm)	Base Cabinet (width 75 cm)	Sink Cabinet (width 105 cm)
Handy Area Storage	<p>Stove-side drawer (Load capacity: 2 kg)</p>	<p>First Drawer (Load capacity: 20 kg)</p>	<p>Upper tier drawer (Tool Pocket) (Load capacity: 20 kg Including Tool Pocket)</p>
	<p>Upper tier drawer (Tool Pocket) (Load capacity: 40 kg Including Tool Pocket)</p>	<p>Upper tier drawer (Load capacity: 40 kg)</p>	<p>Upper tier drawer (Tool Pocket) (Load capacity: 20 kg Including Tool Pocket)</p>
Floor Container	<p>Floor Container (Load capacity: 20 kg)</p>	<p>Floor Container (Load capacity: 20 kg)</p>	<p>Floor Container (Load capacity: 20 kg)</p>

FLOOR CABINET

● means with or without piping space is available.
 ○ means only with piping space is available.
 △ means only without piping space is available.
 ★ stainless steel base plate drawer is optional.
 ※ The above list is showing typical models.
 Please contact your nearest dealer for details.

Sink Cabinets

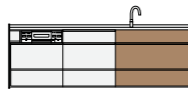

Functions	Inset Panel type with Tool Pocket	With Tool Pocket	Inset Panel type with Tool Pocket + Slide Box	With Tool Pocket + Slide Box
Configuraaion				
Compatible width (cm)	D 650 90 · 105 · 110 ● ★	75 · 90 · 105 · 110 ● ★	90 · 105 · 110 ●	75 · 90 · 105 · 110 ●

Functions	Compatible type for existing drain pipe with Tool Pocket	Inset Panel type	Simple type	Compatible type for existing drain pipe
Configuraaion				
Compatible width (cm)	D 650 75 · 90 · 105 △ ★	*75 · 90 · 105 · 110 ● ★	75 · 90 · 105 · 110 ● ★	75 · 90 · 105 △ ★
	D 600 —	90 · 105 ● ★	75 · 90 · 105 ● ★	75 · 90 · 105 △ ★

Functions	Hinged Door type	Opened Type	Opened Type with Integrated Width 15 cm Slide Open Type Knife Holder
Configuraaion			
Compatible width (cm)	D 650 90 ○	900 · 1050 △	150 ○

* Only SY Sink is available for width 75 cm.

Base Cabinets

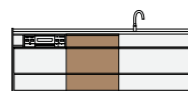

Functions	1 Drawer type	2 Drawers type	2 Drawers type with Slide Box	3 Drawers type
Configuraaion				
Compatible width (cm)	D 650 30 · 45 ● ★	25 · 30 · 45 · 60 · 75 · 90 ● ★	30 · 45 · 60 · 75 · 90 ●	30 · 45 · 60 ● ★
	D 600 30 · 45 ● ★	30 · 45 · 60 · 75 · 90 ● ★	—	—

15 cm width Base Cabinets				
Functions	Hinged Door type	Ladle Rack type	Wire Basket Type (with or without Adjustment Board)	Bottle Storage Type
Configuraaion				
Compatible width (cm)	D 650 45 ○	15 ○	15 ○	15 △
	D 600 —	15 ○	15 ○	15 △

● There are also width 45 cm and 60 cm cabinet for dish washers.

Stove Cabinets



Functions	With Tool Pocket (with or without Adjustment Board)	With Tool Pocket + Slide Box (without Adjustment Board type)	With Tool Pocket + Slide Box (with Adjustment Board type)	Simple type (with or without Adjustment Board)
Configuraaion				
Compatible width (cm)	D 650 75 · 90 · 105 ● ★	75 · 90 · 105 △	75 · 90 · 105 ●	75 · 90 · 105 ● ★
	D 600 —	—	—	75 · 90 · 105 ●

Corner Base Cabinets

Cabinet with wagon



- Width: 90x90 cm
- Depth: 65 cm
- Center: Wagon with door panels
- Inner Cabinet Sides: Drawers with 2 - level trays



Corner wagon Delta Tray



Black color handle is now available.

Cabinet with shelves



- Width: 90x75 cm · 90x90 cm
- Depth: 65 cm
- With Soft Closing Device
- With 2 adjustable shelves

+ OPTION

Towel Rack for Sink Cabinet Drawer



For Line Handle ZKHDTN-K For Short Bar Handle ZKHCAN-K

- ※ Not available for cabinets below.
 - Sink Cabinet (Hinged Door Type)
 - Base Cabinet
 - Stove Cabinet
- ※ In case of the towel rack for Short Bar Handle, it is also not available for the cabinet below.
 - Width 75 cm Sink Cabinet

Rice Dispenser for Floor Container



ZKCFNN-K

Can be stored in Floor Containers with width more than 45 cm and kitchen height higher than 85 cm.

- ※ Except for Sink Cabinet for Existing Piping, Base Cabinet for Deep Type Dish Washer · Dryer, Base Cabinet for Dish Washer · Dryer with 1 Drawer.
 - Capacity: Approximately 11 kg
 - 1 measuring cup (180 ml) included

WALL CABINET

Wall Cabinets

Height 50 cm Short Wall Cabinet, height 60 cm Semi Middle Wall Cabinet, height 70 cm Middle Wall Cabinet, and height 90 cm Long Wall Cabinet are available.

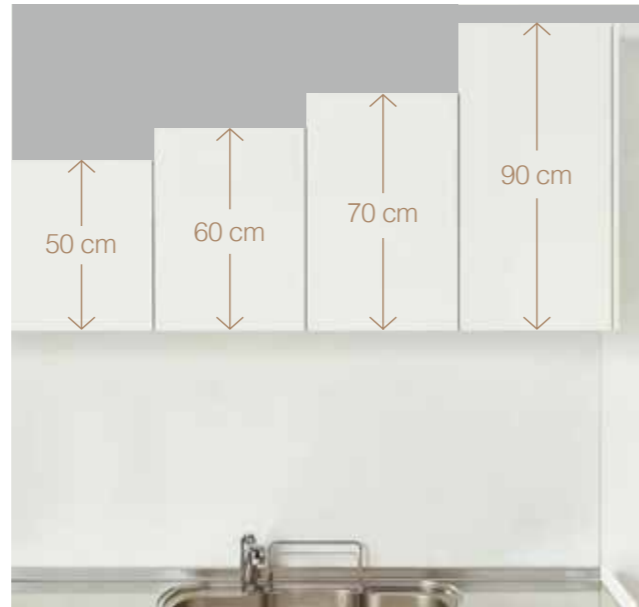

Handle-less Cabinet Doors



Soft Closing Device

Pull Down Wall Cabinet



Spice rack



- Width: 30-45 cm
- Depth: 37.5 cm
- Height: 70 cm
- With one adjustable shelf
- With paper towel rack (Width 45 cm only)

Ladle rack



- Width: 45 cm
- Depth: 37.5 cm
- Height: 70 cm
- With one adjustable shelf
- With Ladle hooks

Move Down Wall Cabinet



- Width: 60-75-90 cm
- Depth: 37.5 cm
- Height: 70 cm
- With load adjusting function (Load capacity 15 kg)



When storing items

Eye Area Box



Store after finish cooking

Select from 2 types depending on how you would like to use

Condiment Rack Type



- Width: 45-75-90 cm
- Depth: 30 cm
- Descending distance: 42 cm (From the bottom of wall cabinet)
- Load capacity: 3 kg
- With paper towel rack (Except width 45 cm)

Drainer Counter Type



- Width: 75-90 cm
- Depth: 30 cm
- Descending distance: 42 cm (From the bottom of wall cabinet)
- Load capacity: 10 kg
- *Shelf must be empty to retract.
- With draining tray

+ OPTION

With cabinets fitted with earthquake proof components, have your kitchen earthquake proof!

Wall cabinet

Detecting shaking from earthquakes etc, doors are automatically locked.



When shaking is detected, the lock cannot be deactivated due to the movement of the ball inside.



The ball inside stabilizes when the shaking stops, so the locked component elevates the lock automatically.

To fill the gap between the ceiling and cabinet.

Ceiling Panel



WALL CABINET

Auto Move

This Wall Cabinet climbs and lowers automatically with the touch of a button to an easy-to-reach height.

Storage made of stainless steel



Select from 4 types depending on how you would like to use

Water Draining & Storage Type

- Width 75 cm Width 90 cm
- Width 120 cm Width 135 cm
- Width 150 cm Width 165 cm
- Width 180 cm



- Width: 75-90-120-135-150-165-180 cm
- Standard: Cutting Board Rack

Dish Drying Rack Type

- Width 75 cm Width 90 cm



- Width: 75-90 cm
- Drying cycle: 30, 60, or 90 min.
- Standard: Cutting Board Rack / Dish Rack / Bowl Drying Rack / Cutlery Rack

Dish Drying Rack & Sterilizer Type

- Width 120 cm Width 135 cm



- Width: 120-135 cm
- Dishcloths & cutting board sterilizer: 120 min.
- Drying cycle: 30, 60, or 90 min.
- Standard setting: dish rack / Bowl drying rack / cutlery rack

Water Draining, Storage, & Sterilizer Type

- Width 150 cm Width 165 cm
- Width 180 cm



- Width: 150-165-180 cm
- Sanitization cycle for dishcloths and cutting boards: Around 120 minutes.

+OPTION

For Water Draining & Storage Type / Water Draining, Storage, & Sterilizer Type



- Support rack (W500) ZAYNZZZD00ZGZ-K
- Dish rack ZAYDZZZD00ZGZ-K
- Cutlery rack ZAYCZZZD00ZGZ-K
- Paper rack ZAYPZZZD00ZGZ-K

For all Types



- Support rack (W300) ZAYMZZZD00ZGZ-K
- Ladle rack ZAYLZZZD00ZGZ-K
- Cloth rack ZAYHZZZD00ZGZ-K

Hand Move



Select from 2 types depending on how you would like to use

Storage Type Width 75 cm Width 90 cm

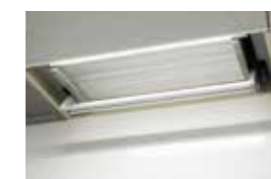

- Width: 75-90 cm
- Depth: 37.5 cm
- Height: 50-60-70 cm
- With LED lighting (Lighting type only)

Water Draining Type Width 75 cm Width 90 cm



- Width: 75-90 cm
- Depth: 37.5 cm
- Height: 50-60-70 cm
- With water pan
- With LED lighting (Lighting type only)

+OPTION

For Storage Type



- Support rack ZKMJNN-K
- Paper rack ZKMJNN-K

For Water Draining Type



- Dish rack ZKMSNN-K
- Ladle rack ZKMENN-K
- Cutting board rack ZKMMNN-K
- Cutlery rack ZKMCNN-K

Slide Pantry

Height 236 cm ^{※1} Height 216 cm ^{※2} Height 186 cm ^{※2} Depth 45 cm Depth 55 cm Depth 65 cm



- Width: 90 · 105 · 120 · 135 · 150 · 180 cm
- Depth: 45 · 55 · 65 cm
- Height: 236 · 216*1 · 186*2 cm

Upper Cabinet

Shelving Type



Move Down Type



※ Available for depth 45 cm and 55 cm.
 ※ Available for Slide Pantry with total width of 120 cm, 150 cm, and 180 cm.

Midsection cabinet

Upper Cabinet for Height 186 cm

Shelving Type



Counter Type



Lower Cabinet

Shelving Type



4 Drawer Type



Step Container Type



Opened Type



Opened Type with 2 Drawers Type



Focused on silent spec



Rail Color



Black

Silver

※1 Height 216 cm is available in depth 45 cm and 55 cm.

※2 Designated upper and lower cabinet must be used for height 186cm. It is available in depth 45 cm.

Cupboard

Height 236 cm [※] Height 216 cm [※] Depth 45 cm Depth 55 cm Depth 65 cm

Translucent Door Type Middle Cabinet



- Width: 45 · 60 · 75 · 90 cm
- Depth: 45 · 55 cm
- Height: 216* · 236 cm

Door Panel Type Middle Cabinet



- Width: 45 · 60 · 75 · 90 cm
- Depth: 45 · 55 · 65 cm
- Height: 216* · 236 cm

Upper Cabinet



- With 1 adjustable shelf

Midsection cabinet



- With 4 adjustable shelves (Height 236 cm)
- With 3 adjustable shelves (Height 216 cm)

Lower Cabinet



- 1st Drawer: With Tray
- 3rd Drawer: With Stabilizer



Doors of the middle cabinet will be an aluminum frame spec when translucent door is selected along with Class 1 · 2 doors.

※ Only depth 45 cm is available for height 216 cm.

Single Sided High Floor Counter

Countertop height 100 cm Depth 45 cm Depth 55 cm



Drawer Type Appliance Storage



- Width: 60·75·90 cm
- Depth: 45·55 cm
- Height: 100 cm
- Upper: Sliding Shelf (No Soft Closing Device), With 2 Electrical Outlets
- Lower: With Stabilizers

Opened Type Appliance Storage



- Width: 60·75·90 cm
- Depth: 45·55 cm
- Height: 100 cm
- Upper: Sliding Shelf (No Soft Closing Device), With 2 Electrical Outlets
- Lower: Opened Space

1 Drawer Type



- Width: 30·45·60·75·90 cm
- Depth: 45 cm
- Height: 100 cm
- 1 Drawer, 1 Adjustable Shelf
- Single Sided High Floor Counter Width: 60~180 cm

Garbage Wagon Type



- Width: 60·75·90 cm
- Depth: 45·55 cm
- Height: 100 cm
- 2 Drawers
- Lower: Opened Space

4 Drawer Type is also available.

High Floor Counter for Corner

Countertop height 100 cm Depth 45 cm

Opened Type for Corner



- Width: 135 cm
- Depth: 45 cm
- Height: 100 cm

Appliance Storage Type for Corner



- Width: 135 · 150 cm
- Depth: 45 · 55 cm
- Height: 100 cm
- Upper: With Inner Drawer, Sliding Shelf (No Soft Closing Device), and 2 Electrical Outlets
- Lower: With Inner Drawer

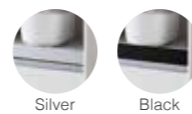

Single Sided Floor Counter

Countertop height 85 cm Depth 45 cm Depth 55 cm Depth 65 cm



1 Drawer Type



- Width: 30·45·60·75·90 cm
- Depth: 45·65 cm
- Height: 85 cm
- 1 Drawer, 1 Adjustable Shelf
- ※ Only widths 45, 60, and 90 cm are available for depth 65 cm.

Garbage Wagon Type



- Width: 60·75·90 cm
- Depth: 45·55 cm
- Height: 85 cm
- 1 Drawer
- Lower: Opened Space

3 Drawer Type



- Width: 30·45·60·75·90 cm
- Depth: 45·55·65 cm
- Height: 85 cm
- 3rd Drawer is with stabilizers

Opened Type



- Width: 60·75·90 cm
- Depth: 45·55 cm
- Height: 85 cm

Wall Oven Cabinet

Width 60 cm Depth 65 cm

Double Tiered Type



※ Oven or microwave can be stored in the middle.

Single tier Type is also available.



Photo is Open Type. Hinged Door Type is also available.



Photo is Step Container Type. Drawer Type is also available.

Cafe Style Storage

Height 236 cm | Depth 45 cm | Depth 55 cm

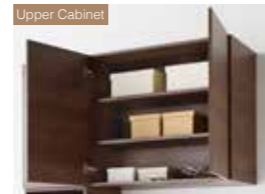

Upper Cabinet
Door Panel Type Wall Cabinet

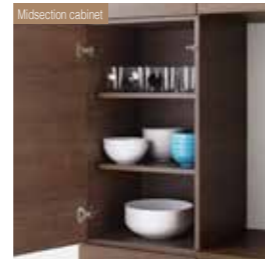

Midsection cabinet
Door Panel Type

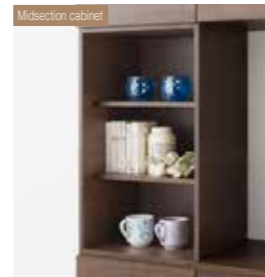

Midsection cabinet
Opened Shelf Type

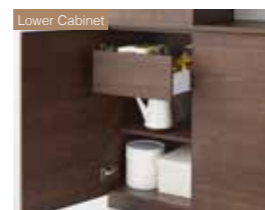

Lower Cabinet
Hinged Door Type (With 1 inner drawer)



Hinged Door Type



Hinged Door Type (With 1 inner drawer)



Opened Type with 1 Drawer



Opened Type

Floor Counter

[Form]



A designated counter for Cafe Style Storage with a slim front edge.

[Color Variation]

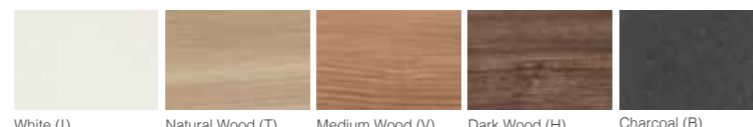

White (I) | Natural Wood (T) | Medium Wood (V) | Dark Wood (H) | Charcoal (B)

Silent Shower Faucet (ZSNET273K14AH)



- Saving Type : Hot Water Saving B
- Water Releasing Form : 3 Level Switching Method
- Silent Shower / Rectifier / Shower
- With Pull Out Hose



Silent Shower



Shower



Rectifier

Eco Shower Faucet (KM5021TEC)



- Saving Type : Hot Water Saving B / C1
- Water Releasing Form : Rectifier / Shower
- With Pull Out Hose



Shower



Rectifier

Design Faucet (Efine)



- Saving Type : Hot Water Saving B / C1
- Water Releasing Form : Rectifier / Shower
- With Pull Out Hose



Chrome Plating
ZZKM6361EC



Matte Black
ZZKM6361ECM5



Matte White
ZZKM6361ECM4

Hot · Cold Water Saving Function (Eco Shower · Design Faucet)

Saves warm water

- Characteristic ① Cold water until the middle
- Characteristic ② Clicks when switching to warm water

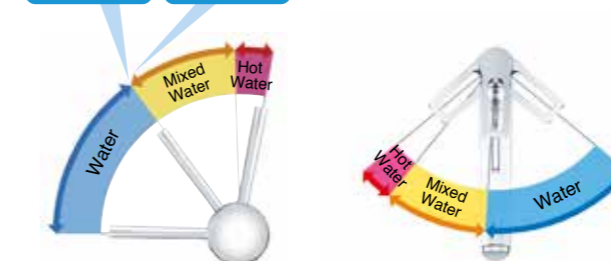

Easy Water Saving Control

- Characteristic ③ Clicks within medium

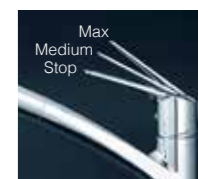
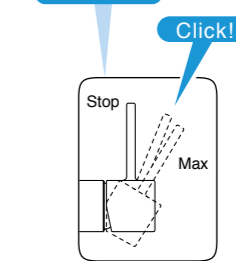

Energy saving structure to naturally save warm water

Hot Water Saving Faucet

It is a hot water · energy saving product certified by Japan Valve Manufacturer's Association under "The evaluation criteria of the owner of certain building or builder regarding energy usage rationalization" and "The evaluation criteria of housing business owner".

The evaluation criteria of the owner of certain building or builder regarding energy usage rationalization.	Hot Water Saving Faucet	Easy to turn off easily at hand. (9% reduced from conventional type.)
	Hot Water Saving C1	Hot water is not released during cold water release. (30% reduced from conventional type.)
The evaluation criteria of housing business owner	Hot Water Saving A	Easy to turn off easily at hand. (9% reduced from conventional type.)
	Hot Water Saving B	Optimum flow rate is less than 5 ℓ/min. (17% reduced from conventional type 6 ℓ/min.)
	Hot Water Saving AB	Meets standards of Hot Water Saving A and B. (24% reduced from conventional type.)

Optional Parts for Drawers

Attachment position



Parallel Stabilizer (Single)

1 2 3



【For cabinet without adjustment board • inset panel】

- 105 cm width : ZKH105CN-K
- 90 cm width : ZKH090CN-K
- 75 cm width : ZKH075CN-K
- 60 cm width : ZKH060CN-K
- 45 cm width : ZKH045CN-K
- 30 cm width : ZKH030CN-K

【For cabinet with adjustment board • inset panel】

- 105 cm width : ZKH105DN-K
- 90 cm width : ZKH090DN-K
- 75 cm width : ZKH075DN-K

※ Unavailable for drawers with Slide Box.

Bottle Stand

2



- 90 cm width : ZKH090EN-K
- 75 cm width : ZKH075EN-K
- 60 cm width : ZKH060EN-K
- 45 cm width : ZKH045EN-K
- 30 cm width : ZKH030EN-K

Ladle Pocket

1 2 3



ZKHXWN-K

Frying Pan Rack

1



ZKHGNN-K

※ Unavailable for drawers with Tool Pocket and Slide Box.

Cleanup Corporation

Production centers

2 locations



Katsuta-gun, Okayama Prefecture

- Okayama Factory 40.000 m²
Systemized Kitchens
- Tsuyama Factory 27.931 m²
Systemized Kitchens, stainless steel counters

8 locations



Iwaki, Fukushima Prefecture

- Yotsukura Factory 140.000 m²
Systemized Kitchens, bathroom vanities
- Kashima System Factory 105.000 m²
Systemized Kitchens
- Kashima Factory 34.000 m²
Modular bathrooms
- Yumoto Factory 33.000 m²
Stainless steel kitchen Countertops
- Crete Factory 32.000 m²
Synthetic marble bathtubs and Countertops
- Crete No.2 Factory 28.000 m²
Synthetic marble kitchen Countertops
- Cleanup Steel Processing Co., Ltd.
Kashima Art Factory 13.200 m²
Stainless steel coloring processes
- Cleanup Steel Processing Co., Ltd.
Noda Factory 11.200 m²
Stainless steel cutting processes

Corporate Data

Head Office	6-22-22 Nishi-nippori, Arakawa-ku, Tokyo 116-8587 Tel: +81-3-3894-4771 (Main switchboard) http://cleanup.jp/
Founded	October 5, 1949
Employees	3,454 (As of March 2021)
Listed on the Tokyo Stock Exchange	September 2, 1991
ISO Certifications	ISO9001 & ISO14001

"Systemized Kitchen" We will keep improving.

An ideal kitchen where color, size, functions, layout can be chosen freely.
 To be able to provide your dream kitchen which was only available by custom order.
 The dream came true in Japan when Cleanup released its first "Systemized Kitchen" in 1973.
 A products that was born without any concepts.
 The name "Systemized Kitchen" which was named by Cleanup was accepted by countless customers and it has become a common noun.
 An ideal kitchen must use an ideal material. 2 years after the "Systemized Kitchen" was born, the first ever stainless steel kitchen with stainless steel inner structure was released.
 As a matter of fact, wooden cabinet is still generally used for systemized kitchens.
 To make the structure stainless steel requires certain skills and cost.
 Without high level stainless steel technology, systemized kitchen with stainless steel cabinets will not be implemented.
 In 2011, stainless steel cabinet became a standard for middle-high range systemized kitchens.
 A product using the ideal material towards every corner was born.
 With the clean and durable kitchen, history of kitchen was changed.
 And now, "STEDIA" will take Japan's systemized kitchen to another level.

- 1973 ○ The first Systemized Kitchen in Japan developed.
- 1975 ○ Stainless steel sink stand released.(First ever in the industry)
- 1983 ○ Simply installable Systemized Kitchen released.(First ever in the industry)
- 1998 ○ All slide storage system released.(First ever in the industry)
- 1999 ○ Foot level storage Floor Container released.(First ever in the industry)
- 2004 ○ The first stainless steel sink integrally molded with drainage released.
- 2005 ○ Super Silent e-Sink released.(First ever in the industry)
- 2007 ○ Self Cleaning Cooker Hood released.(First ever in the industry)
- 2011 ○ Stainless steel cabinet standardized for middle-high range systemized kitchens
- 2015 ○ Stream Flow Sink released
- 2018 ○ **STEDIA Debut**



Stainless steel cabinet's strength and beauty was proven by a kitchen which was used more than 30 years.

Sakura DX



In 1975, Cleanup released the very first stainless steel cabinet kitchen in the industry "Sakura DX". The kitchen in the pictures is an actual kitchen used in a general home for more than 30 years. After examining, there was no mold or rust. And based on analysis of the frame structure, it was not a problem at all to keep using the kitchen.



Every part remained clean including the rear and inside of the cabinet.
 The shine of stainless steel was maintained for more than 30 years.



STEDIA is the fruit of skills that Cleanup has been improving.

STEDIA will keep shining because it is using stainless steel with outstanding durability. To be able to process stainless steel with high durability is extremely complicated. Cleanup's factories are evolving by machinery upgrades and enhancing IT technologies. However, the finishing process of sinks and countertops are conducted by our skilled well experienced engineers called "Meisters".

